





Bollards for ropes to 16mm (5/8")		mm			mm Ø inch Ø	mm Ø Gauge	Gms Ozs
		A	B	C			
Clam-Bollard CL208 (Nylon)	6 - 10 1/4 - 3/8	85 ⁰ 3 3/8	65 2 9/16		M6 1/4	6.3 No14	67 2.4
Clam-Bollard Major CL210 (Nylon)	10 - 16 3/8 - 5/8	99 ⁰ 3 3/8	76 3		M8 5/16	8 No16	141 5.0



Spring-gate Cleats for ropes to 12mm (1/2")		mm			mm Ø inch Ø	mm Ø Gauge	Gms Ozs
		A	B	C			
Vertical with Spring-gate CL237 (Nylon)	6 - 12 1/4 - 1/2	95 3 3/4	72 2 13/16	40 1 5/8	M6 1/4	6.3 No14	47 1.7
Racing Vertical with Spring-gate CL238 (Aluminium)	6 - 12 1/4 - 1/2	90 3 9/16	72 2 13/16	40 1 5/8	M6 1/4	6.3 No14	75 2.6

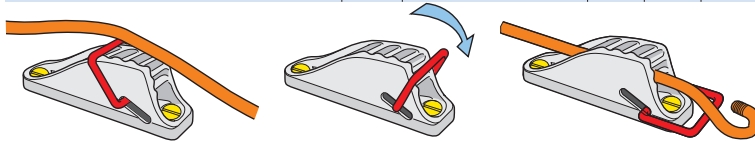

Spring-gate Cleats for ropes to 16mm (5/8")		mm			mm Ø inch Ø	mm Ø Gauge	Gms Ozs
		A	B	C			
Major with Spring-gate CL239 (Nylon)	10 - 16 3/8 - 5/8	122 4 13/16	95 3 3/4	49 2	M8 5/16	6.3 No14	88 3.2
Racing Major with Spring-gate CL240 (Aluminium)	12 - 16 1/2 - 5/8	118 4 5/8	95 3 3/4	50 2	M8 5/16	6.3 No14	166 5.9



Cleats for ropes to 16mm (5/8")		mm			mm Ø inch Ø	mm Ø Gauge	Gms Ozs
		A	B	C			
Major CL205 (Nylon)	10 - 16 3/8 - 5/8	122 4 13/16	95 3 3/4	36 1 7/16	M8 5/16	6.3 No14	85 3.0
Racing Major CL220 (Aluminium)	12 - 16 1/2 - 5/8	118 4 5/8	95 3 3/4	37 1 1/2	M8 5/16	6.3 No14	163 5.7
Uncoated Racing Major CL220 (Aluminium)	12 - 16 1/2 - 5/8	118 4 5/8	95 3 3/4	37 1 1/2	M8 5/16	6.3 No14	163 5.7
Fairlead for CL205, CL220, CL239 & CL240 CL2245 (Stainless Steel)	-	50 1 31/32	-	41 1 5/8	M8 5/16	6.3 No14	72 2.5
Tapered Pad CL805 (Polypropylene)	-	131 5 1/8	-	45 1 3/4	M8 5/16	6.3 No14	35 1.2



The CL220VB and CL219VB, with uncoated finish, for welding to an aluminium substrate.

